



SmartBright Projector ST031T

ST031T LED20/840 21W 220-240V I WB BK GM

Power supply unit - Narrow beam - Opal diffuser in polycarbonate cover -

SmartBright ST031T is a new design projector with nice look and feel and reliable quality, bring the excellence user experience to end users.

Warnings and Safety

- The luminaire should be installed by a qualified electrician and wired in accordance with the latest IEC-60364-7-714 regulations.
- Do not switch on the luminaire before installation is fully completed.
- Before using and when the luminaire is switched on, earthing is required.
- The luminaire should be replaced immediately if any crack or deterioration happens.
- The light source of this luminaire is not replaceable; when the light source reaches its end of life the whole luminaire shall be replaced.
- The corrosive atmosphere or hazardous materials such as sulfur, chlorine, phthalate, etc. must be avoided during the use and storage.

Product data

General information		Luminaire light beam spread	
Beam angle of light source	- °	Control interface	-
Light source color	840 neutral white	Connection	External connector
Light source replaceable	No	Cable	-
Number of gear units	1 unit	Protection class IEC	Safety class I
Driver/power unit/transformer	Power supply unit	Glow-wire test	Temperature 650 °C, duration 30 s
Driver included	Yes	Flammability mark	-
Optic type	Narrow beam	CE mark	CE mark
Optical cover/lens type	Opal diffuser in polycarbonate cover	ENEC mark	-

SmartBright Projector ST031T

Warranty period	3 years
Constant light output	No
Number of products on MCB of 16 A type B	30
EU RoHS compliant	Yes
Light source engine type	LED

Operating and electrical

Input Voltage	220 to 240 V
Input Frequency	50 or 60 Hz
Initial CLO power consumption	- W
Average CLO power consumption	- W
Inrush current	42.8 A
Inrush time	0.0092 ms
Power Factor (Min)	0.9

Controls and dimming

Dimmable	No
----------	----

Mechanical and housing

Housing Material	Aluminum extruded
Reflector material	Polycarbonate
Optic material	Polycarbonate
Optical cover/lens material	Polycarbonate
Fixation material	-
Optical cover/lens finish	Opal
Overall length	185 mm
Overall width	60 mm
Overall height	185 mm
Overall diameter	60 mm
Color	Black

Approval and application

Ingress protection code	IP20 [Finger-protected]
Mech. impact protection code	IK02 [0.2 J standard]

Initial performance (IEC compliant)

Initial luminous flux (system flux)	2000 lm
Luminous flux tolerance	+/-10%
Initial LED luminaire efficacy	95 lm/W
Init. Corr. Color Temperature	4000 K
Init. Color Rendering Index	>80
Initial chromaticity	(0.3858,0.3818) SDCM≤5
Initial input power	21 W
Power consumption tolerance	+/-10%

Over time performance (IEC compliant)

Median useful life L70B50	30000 h
Median useful life L80B50	20000 h
Median useful life L90B50	8500 h

Application conditions

Ambient temperature range	-20 to +40 °C
Maximum dim level	Not applicable
Suitable for random switching	Not applicable

Product data

Full product code	871016335941099
Order product name	ST031T LED20/840 21W 220-240V I WB BK GM
EAN/UPC - Product	8710163359410
Order code	911401874180
Numerator - Quantity Per Pack	1
Numerator - Packs per outer box	10
Material Nr. (12NC)	911401874180
Net Weight (Piece)	0.300 kg



Dimensional drawing

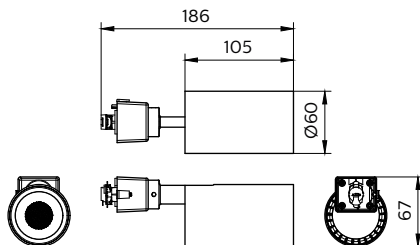

ST031T LED20/840 21W 220-240V I WB BK GM

SmartBright Projector ST031T

